

DCS-8010LH HD Wi-Fi Camera



Product Highlights



High Definition Clarity
HD quality video



Motion & Sound Detection
Receive alert notifications and record video clips



Cloud Recording
Automatically back up video clips to the cloud for anytime access

Your Home, Only Smarter.

The DCS-8010LH HD Wi-Fi Camera boasts a 120-degree wideangle lens that easily captures your entire room, wall-to-wall, in high definition. You will know what's happening day or night with built in night vision, motion and sound detection sending notifications to the mydlink app. The rotatable head makes discrete installations easy even on ceilings.

Peace of Mind with 24/7 Complete Coverage

The DCS-8010LH uses a wide-angle lens and an HD sensor to give you a clear view of an entire room with a single camera. Night-time monitoring is possible with the built-in infrared LEDs which allow for night time viewing of up to 16 feet, enabling round-the-clock monitoring of a home or small office. The special fold-out design makes ceiling, wall, and counter-top installations a breeze and wireless 802.11n keeps cabling to a minimum.

Get Notifications Wherever You Are

The DCS-8010LH helps you keep watch over the things that are important to you with built-in motion detection that can send push notifications to your mobile phone and automatically record snapshots and video clips to a microSD card or to your cloud account. Sound detection will notify you of loud noises, such as a baby crying or glass breaking, making it ideal for use as a baby monitor or office camera.

Do it All with the mydlink[®] App

Now enhanced with the new mydlink[®] app, the DCS-8010LH makes it easier and more convenient for you to look after your family at home or check in on your office — from anywhere with Internet access. Simply install the app on your mobile device and you'll be able to set up, view, and manage your camera using your tablet or mobile phone.³ With the mydlink[®] app, you will always feel protected.

Features

- ◆ High quality HD sensor provides detailed snapshots and crisp video
- ◆ Built-in IR LEDs to capture video in low-light environments, or even complete darkness up to 5m (16 ft)
- ◆ Motion detection and sound level detection
- ◆ Uses Wireless N so you can install the camera anywhere with ease
- ◆ Backwards compatible with 802.11b/g
- ◆ View and manage your camera using the mydlink[®] app
- ◆ Push notification for events and save video clips to microSD card or cloud storage
- ◆ Pinch to zoom allows for closer looks on what is happening in the room
- ◆ AES128-encrypted video and audio streaming

Anytime, Anywhere Access with mydlink® Cloud Recording

Enhanced with mydlink® cloud recording support, the DCS-8010LH makes it easy and convenient for you to look after your family and check up on your home or office. With a mydlink® cloud recording subscription, you can have peace of mind with your video recordings sent automatically to a cloud server. Play back recordings from the cloud or download video clips to your mobile device from anywhere, anytime through the Internet. Access real-time live views of your cameras using the mydlink® mobile app and set automated schedules via your mobile device, no matter where you are.

Product Image

Front View

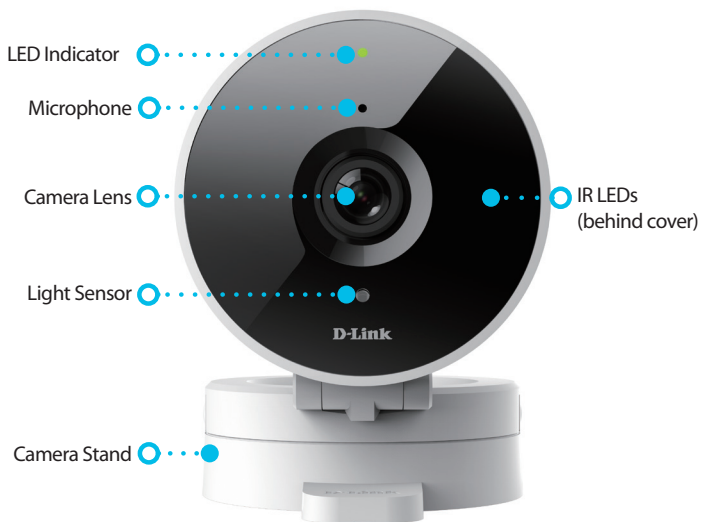

Connections View

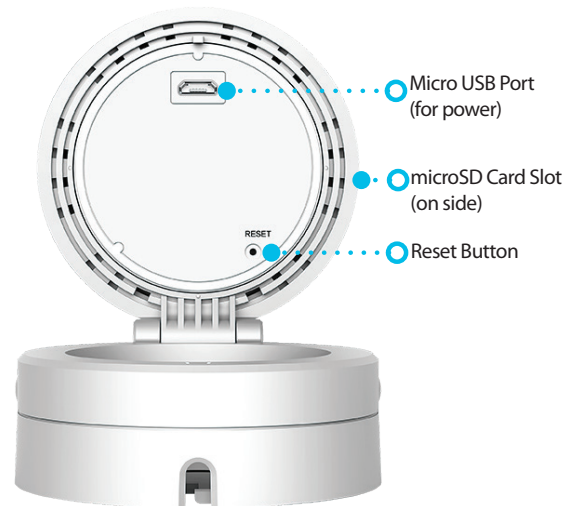

Technical Specifications

Camera		
Hardware Profile	<ul style="list-style-type: none"> • 1/4" megapixel HD progressive CMOS sensor • 5m (16 ft) IR illumination distance • Minimum illumination: <ul style="list-style-type: none"> • Color (Day Mode), IR LEDs off: 2.2 lux • Built-in Infrared-Cut Removable (ICR) Filter module • Fixed length 2.55 mm 	<ul style="list-style-type: none"> • Aperture F2.2 • Angle of view (16:9): <ul style="list-style-type: none"> • Horizontal: 96° • Vertical: 53° • Diagonal: 120° • Built-in microphone
Image Features	<ul style="list-style-type: none"> • Configurable image size • Configurable sound level detection 	<ul style="list-style-type: none"> • Configurable motion detection windows
Video Compression	<ul style="list-style-type: none"> • Simultaneous H.264/MJPEG format compression 	<ul style="list-style-type: none"> • JPEG for still images
Video Resolution	<ul style="list-style-type: none"> • 720p (1280 x 720), VGA (640 x 352) at up to 30 fps 	
Audio Support	<ul style="list-style-type: none"> • MPEG-2 AAC LC 	
Network		

Connectivity	<ul style="list-style-type: none"> • 802.11b/g/n wireless with WPA/WPA2 encryption • Operates on 2.4 GHz band • microSD card slot² 	<ul style="list-style-type: none"> • Single-band 2T2R mode supports a maximum data rate of 72.2 Mbps (PHY rate) using 20 MHz bandwidth¹ • Bluetooth 2.1/3.0/4.0
Network Protocols	<ul style="list-style-type: none"> • IPv4, IPv6, ARP, TCP, UDP, ICMP • DHCP Client • DNS Client 	<ul style="list-style-type: none"> • RTSP/SRTSP • HTTPS • Bonjour
System Integration		
Event Management	<ul style="list-style-type: none"> • Motion detection • Sound detection • Cloud recording 	<ul style="list-style-type: none"> • Manually taken snapshots and video clips saved to mobile device • Push Notification
Mobile Support	<ul style="list-style-type: none"> • mydlink[®] app for iPhone, iPad, Android phone and tablet 	
Physical		
Environment	<ul style="list-style-type: none"> • For indoor use only 	
Weight	<ul style="list-style-type: none"> • 140 g (4.94 oz) ± 5% (with stand) 	
Power Adaptor	<ul style="list-style-type: none"> • Input: 100 to 240 V AC, 50/60 Hz 	<ul style="list-style-type: none"> • Output: 5 V DC 1.2A (Micro-USB)
Power Consumption	<ul style="list-style-type: none"> • Maximum 5 W ± 5% 	
Temperature	<ul style="list-style-type: none"> • Operating: 0 to 40 °C (32 to 104 °F) 	<ul style="list-style-type: none"> • Storage: -20 to 70° C (-4 to 158 °F)
Humidity	<ul style="list-style-type: none"> • Operating: 20% to 80% non-condensing 	<ul style="list-style-type: none"> • Storage: 5% to 95% non-condensing
Certifications	<ul style="list-style-type: none"> • CE • CE LVD • RCM 	<ul style="list-style-type: none"> • FCC Class B • ICES
Dimensions (L x W x H)	<ul style="list-style-type: none"> • 92.1 x 65.9 x 90.7 mm (3.6 x 2.6 x 3.6 in) 	
	<p>The image contains two technical drawings of the camera. The left drawing is a side view showing the camera's profile. It has a total length of 92.1 mm and a height of 23.1 mm. A detail of the top edge shows a width of 26.9 mm and a microSD card slot. The right drawing is a front view showing the camera's circular lens and mounting base. The lens has a diameter of 65.6 mm. The base has a width of 65.9 mm and a height of 90.7 mm.</p>	

Order Information

<i>Part Number</i>	<i>Description</i>
DCS-8010LH	HD Wi-Fi Camera

¹ Maximum wireless signal rate derived from IEEE standard 802.11n specifications. Actual data throughput will vary. Network conditions and environmental factors, including volume of network traffic, building materials and construction, and network overhead, lower actual data throughput rate. Environmental factors will adversely affect wireless signal range.

² Camera is compatible with microSD/SDHC/SDXC cards up to v3.01. Camera is not compatible with v4.x cards.

³ Please refer to the app's store page for device compatibility requirements.

Version 1.00 (US)

Updated 3/2/2018